

Bowen Preserve **(Trail head at 69 Angell Road)**

The 20-acre preserve is the Land Trust's only trail south of Route 295. Off road parking is available for a handful of cars on the grassy area.

Between 1995 and 1999 the Land Trust purchased three parcels on the southeast side of Angell Road.

The land is an island oasis for the neighborhood that surrounds this beautiful woodland. The streets that make up our neighbors are Deborah and Will Croft to the north. The streets to the south side of the property are Red Gate and Stonebridge Roads.

The land is mixed forest and wetlands with one flowing brook that feeds into a pond on the property that then flows across Angell Road connecting to Scott Brook that flows into the Blackstone River. Since the north side of the Preserve is highly sloped, the property serves as a drainage area for the north neighborhood.

While the preserve is small it allows for two short trails. The main trail dead ends into private property. The second trail loops to the pond and then to Stonebridge Drive where there is parking for a few cars.

The preserve is a refuge for wildlife such as Great blue herons (pictured) and red-tailed hawks have been sighted. Marsh marigolds and low bush blueberries are just a few of the many native plants to be found on the property. In its natural state, free from future development, it provides an assurance of quality of life for the neighborhood.



Cumberland Land Trust
P O Box 8011
Cumberland, R I 02864

www.CumberlandLandTrust.org

Printed courtesy of
Navigant Credit Union



The Veronica A. Geddes Bowen Wildlife Preserve Conservation Area at Angell Road



***For state wide trails visit:
www.ExploreRI.org***

Veronica A. Geddes Bowen Wildlife Preserve

Map created by the

Cumberland Land Trust

in partnership with

B.G. Hooke Consulting

and the

RI Land Trust Council

July 2015

**Please Stay
on
Marked Trails**

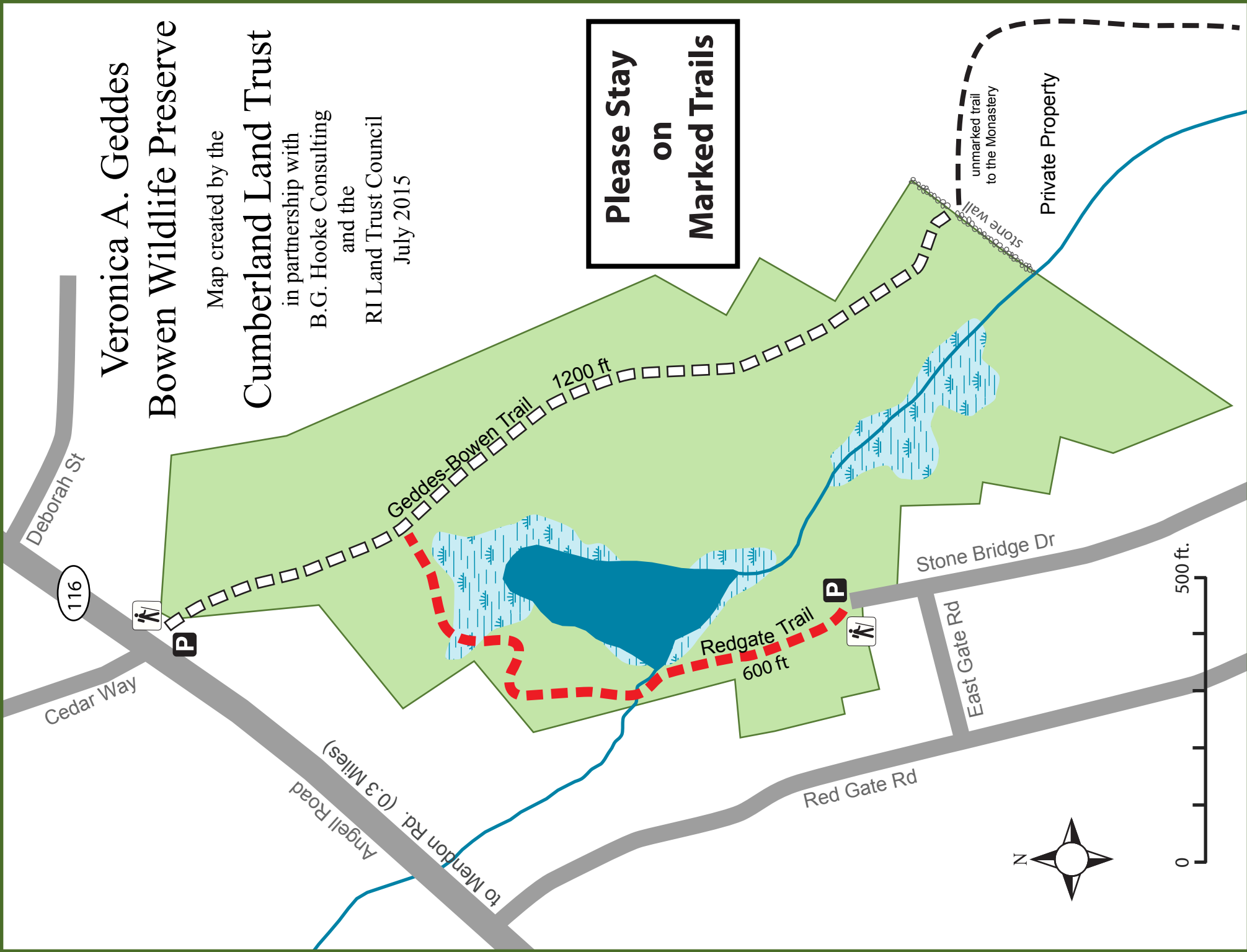

Stone wall
unmarked trail
to the Monastery

Private Property

